

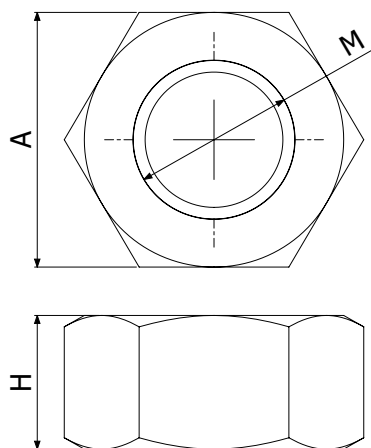

CHARACTERISTICS



Models: M6, M8, M10.

Finishes: EZ, ss304.

Characteristics:

- Hexagon Nut (mounting wrench)

Dimensions:

MODEL	M(mm)	A (mm)	H (mm)	T (N-m)
M6	6	10	5	8
M8	8	13	6,5	15
M10	10	17	8	35
M12	12	19	9,7	40

USE INSTRUCTIONS

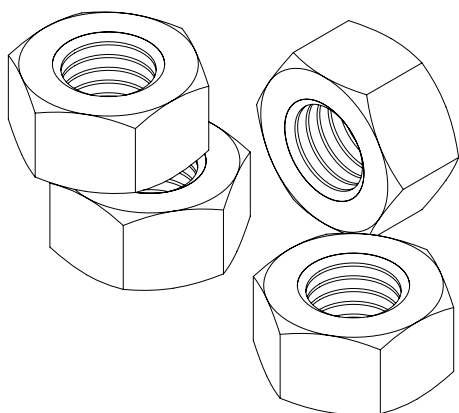

- For the assembly, a key of the dimension indicated in the above table is required.
- Compatible with all Metric threaded bolts.
- They are used in the fixation of CONDUIT metal shafts together with pressure washers.